

Server Lifters

The range of server lifters from EDP Europe are designed to tackle the challenges of manoeuvring IT equipment around the data centre environment. Unlike the more traditional bulky server lifting alternatives, our range of server lifters are both lightweight and portable and easy to operate.

Battery Operated Server Lifters

Classic Range



The Classic range of EDP battery operated server lifters are manufactured using lightweight aluminium and rigid steel, and finished with a two part epoxy resin coat. All models include sealed-for-life, maintenance free 24 volt batteries that feature an integral auto cut-off charger. Operation is via a push button controller that can be hand held or used from its handle-mounted holster.

Features & Benefits

- Models are available with standard height or extending masts for extra reach.
- Dual speed elevation and descent for controlled lifting.
- Attractive design with soft grip bull bar handles.
- Battery charge meter.
- Stainless steel bearings are fitted in the four non-marking all-swivelling wheels, rear wheels all have total stop brakes.
- Trip mechanism prevents descending lift lowering onto any obstacle.
- Provides greater protection to equipment and operators during installation process.
- Available in a choice of lifting capacities that ranges from 80Kg to 400Kg.
- Maximum height reach of 1760mm (39U) on the 80Kg extended mast model (49-SL-85EM).
- Most available from stock for short leadtime.



Available models are shown in the table below.

Part Number	Weight Capacity	Lowered Height	Raised Height	Platform (WxD)	Weight
49-SL-85	85Kg	125mm	1440mm (32U)	600mm x 470mm	39Kg
49-SL-85EM	80Kg	125mm	1760mm (39U)	600mm x 470mm	42Kg
49-SL-105	105Kg	130mm	1345mm (30U)	600mm x 470mm	42Kg
49-SL-105EM	100Kg	130mm	1655mm (37U)	600mm x 470mm	45Kg
49-SL-155	155Kg	130mm	1345mm (30U)	600mm x 470mm	43Kg
49-SL-155EM	150Kg	130mm	1655mm (37U)	600mm x 470mm	45Kg
49-SL-205	205Kg	105mm	1320mm (29U)	560mm x 600mm	64Kg
49-SL-250	250Kg	105mm	1320mm (29U)	560mm x 600mm	105Kg
49-SL-400	400Kg	85mm	1700mm (38U)	Forks 650mm x 100mm	138Kg

Telescopic Mast Server Lifter

The Battery Operated 49-SL-205 is also available with telescopic mast to provide higher positioning of equipment, whilst making it easier to navigate through doorways or aisle containment systems.

Part Number	Weight Capacity	Lowered Height	Raised Height	Platform (WxD)
49-SL-205TELE	100Kg	105mm	2464mm (55U)	600mm x 470mm



Slim-Line Lite Range



The Slim-Line Lite range of server lifters offer outstanding manoeuvrability, intuitive control unit and stylish appearance.

Features & Benefits

- Low self weight - manufactured from anodised aluminium mast and steel carriage with precision ball bearings.
- Fast lifting time of 125mm/second.
- Easy to use control unit with state-of-the-art, fingertip control switchgear.
- All moving parts are shielded for increased safety, with overload protection and security clutch.
- Excellent manoeuvrability and near silent operation.
- 400mm Load centre.
- Host of accessories to adapt the server lifter for other lifting purposes.
- Slim-Line Lite range lifts up to 90Kg*.

* Model dependant

Available models are shown in the table below.

Part Number	Weight Capacity	Lowered Height	Raised Height	Platform (WxD)	Weight
49-SL-70S	70Kg	112mm	1062mm (23U)	400mm x 450mm	27Kg
49-SL-70	70Kg	112mm	1357mm (30U)	400mm x 450mm	28Kg
49-SL-70EM	70Kg	112mm	1757mm (39U)	400mm x 450mm	30Kg
49-SL-90S	90Kg	112mm	1062mm (23U)	400mm x 450mm	27Kg
49-SL-90	90Kg	112mm	1357mm (30U)	400mm x 450mm	28Kg
49-SL-90EM	90Kg	112mm	1757mm (39U)	400mm x 450mm	30Kg

Leg frames for SL-70 and 90 series

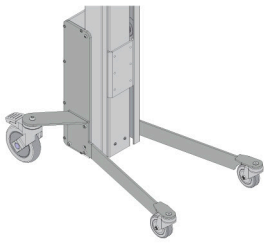

Angled Leg Frame
The unique design gives you free foot space, optimum stability and absolutely the best manoeuvrability.

Available for all models.
Standard legs for 49-SL-70, 49-SL-70EM, 49-SL-90 and 49-SL-90EM

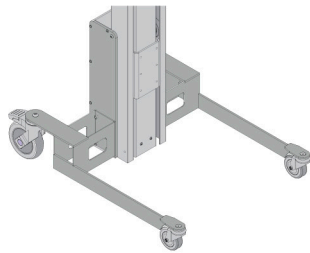

Box Leg Frame
Allows forks to go all the way down to the floor, used to lift plastic boxes etc.

Available for all models.

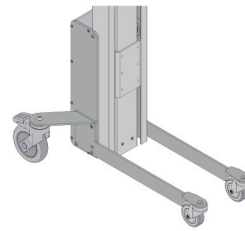

Straight Leg Frame
The narrow legs give the lift trolley access to run in under the pallets and chassis. Used where boxes or other goods must be lifted directly from pallets.

Available for 49-SL-70S, 49-SL-70, 49-SL-90S and 49-SL-90

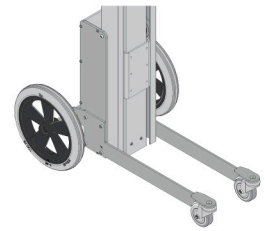

Sack Truck Leg Frame
The large wheels mean that it is no problem to pull the lift trolley over thresholds and edges, and also help to protect fragile loads (rear wheels without brakes).

Available for 49-SL-70S, 49-SL-70, 49-SL-90S and 49-SL-90
Standard legs for 49-SL-70S and 49-SL-90S

Slim-Line HD Range



The Slim-Line HD range of server lifters provide heavy duty lifting whilst still offering outstanding manoeuvrability, with a stable and flexible design.

Features & Benefits

- Manufactured from anodised aluminium mast and steel carriage with precision ball bearings.
- 24V DC motors driven by steel reinforced cam belts.
- Fast lifting time of 125mm/second with 270mm/second possible on 'Q' models.
- Control unit equipped with soft start and stop, with an intuitive button on the control panel.
- All moving parts are shielded for increased safety, with overload protection and security clutch.
- Excellent manoeuvrability and near silent operation.
- 400mm Load centre.
- Host of accessories to adapt the server lifter for other lifting purposes.
- Slim-Line HD range lifts up to 200Kg*.

* Model dependant

Available models are shown in the table below.

Part Number	Weight Capacity	Lowered Height	Raised Height	Platform (WxD)	Weight
49-SL-80	80Kg	102mm	1303mm (29U)	495mm x 495mm	30Kg
49-SL-80EM	80Kg	102mm	1703mm (38U)	495mm x 495mm	31Kg
49-SL-90SQ	90Kg	110mm	1302mm (29U)	495mm x 495mm	43Kg
49-SL-90Q	90Kg	110mm	1702mm (38U)	495mm x 495mm	45Kg
49-SL-90EMQ	90Kg	110mm	2102mm (47U)	495mm x 495mm	47Kg
49-SL-130S	130Kg	102mm	1302mm (29U)	500mm x 400mm	43Kg
49-SL-130	130Kg	102mm	1702mm (38U)	500mm x 400mm	45Kg
49-SL-130EM	130Kg	102mm	2102mm (47U)	500mm x 400mm	47Kg
49-SL-200	200Kg	84mm	1682mm (37U)	500mm x 400mm	57Kg
49-SL-200EM	200Kg	84mm	2084mm (46U)	500mm x 400mm	59Kg

Manual Server Lifters

The EDP manually operated server lifters provide a cost effective, maintenance free solution to moving and positioning IT equipment.



Features & Benefits

- Weight capacity ranges from 85Kg to 400Kg.
- Available in powder coated mild steel as standard.
- "Easy Winch" system is used to raise and lower the load safely with the minimum of manual effort.
- Automatic braking function prevents uncontrolled lowering.
- Lifts are remarkably manoeuvrable and extremely lightweight.
- All four wheels swivel and two are fitted with total stop brakes complete with toe guards.
- High level stability and durability.

Part Number	Weight Capacity	Lowered Height	Raised Height	Platform (WxD)	Weight
49-WPM-85	85Kg	140mm	1560mm (35U)	600mm x 470mm	34Kg
49-WPM-140	140Kg	130mm	1605mm (36U)	600mm x 500mm	45Kg
49-WPM-200	200Kg	130mm	1430mm (32U)	600mm x 500mm	55Kg
49-WPM-400	400Kg	85mm	1200mm (26U)	Forks 650mm x 100mm	84Kg
49-WPM-400EM	400Kg	85mm	1500mm (33U)	Forks 650mm x 100mm	90Kg
49-WPM-400EEM	400Kg	85mm	1700mm (38U)	Forks 650mm x 100mm	110Kg

Ver: EDPSL0517.1